

OFFICE OF THE  
FIRST SELECTMAN

Telephone (203) 563-0100  
Fax (203) 563-0299

Email to:

lynne.vanderslice@wiltonct.org

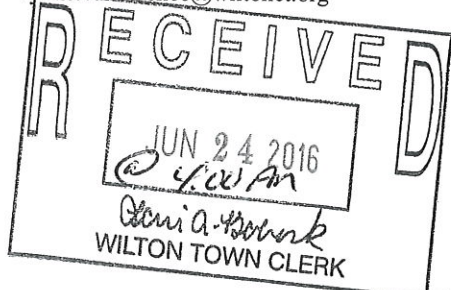

Lynne A. Vanderslice  
*First Selectman*

Michael P. Kaelin  
*Second Selectman*

David K. Clune  
*Selectman*

Lori A. Bufano  
*Selectman*

Richard J. Dubow  
*Selectman*

TOWN HALL  
238 Danbury Road  
Wilton, CT 06897

**BOARD OF SELECTMEN  
MONDAY JUNE 6, 2016**

**MEETING ROOM B, WILTON TOWN HALL**

**PRESENT:** First Selectman Lynne Vanderslice, Richard Dubow, Michael Kaelin, David Clune, Lori Bufano

**GUESTS:** Bob Nerney, Mike Conklin, Steve Pierce, Sarah Gioffre, Members of Kiwanis, John Savarese, Anne Kelly-Lenz, Sarah Taffel,

**OTHERS:** Members of the Press and Members of the Public

Ms. Vanderslice called the meeting to order at 7:31 p.m.

**A. Consent Agenda**

Motion made to by Ms. Bufano to approve the consent agenda as follows, seconded by Mr. Kaelin and unanimously carried. Mr. Dubow abstained from approving the May 25, 2016 Board of Selectmen Special Meeting as he was not present at the meeting.

Minutes

- Board of Selectmen Meeting – May 16, 2016, 2016
- Board of Selectmen Special Meeting – May 25, 2016

Gifts

- PPG Give Volunteer Program for Wilton CERT – \$500.00

**B. Discussion and/or Actions**

**1. River Road Project**

Mike Conklin, Director of Environmental reviewed the River Road Project. Mr. Conklin noted that Ms. Vanderslice asked him to look into the invasive plant species around Schencks Island and to come up with a plan to control the invasive species. He noted that the Conservation Commission and the Land Trust currently manage the meadow inside of Schencks but very little has been done to manage invasive plant species around the property. Mr. Conklin worked with Suzanne Knutson who is a volunteer to the Town and

walked the property. Ms. Knutson is a landscape designer who volunteered her services to draft a plan for Schenks Island (copy of the plan is attached). Primary section focused on across the street from the Stop & Shop Plaza between River Road and the Norwalk River as well as three sections down toward Horseshoe Pond focusing on removing invasive plant species and installing new native plant species in those areas. Work has been underway to remove invasive species since Spring. Work underway is opening views to the river and the project overall will be opening up public access to the river. Feedback from the Conservation Commission and wetland permits from the Inland Wetlands Commission were received as well as review and comment from the Wilton Center Architectural Review Board before proceeding with the project.

Mr. Conklin noted that Kiwanis approached the town about helping with the project. They wanted to enhance the area beyond just the removal of invasive species and replanting. Kiwanis made a donation of \$17,000 to help with the project. Their donation will pay for the initial tree removal, landscaping, the creation of the space, one wheelchair accessible game table, a 36-in. granite seal (which is like a ground level monument) and the relocation of the League of Women Voters adopt-a-spot sign. The \$17,000 gift from Kiwanis along with two anonymous gift donations will allow the town to install three chess tables (one of which will be wheelchair accessible) and benches to encourage people to gather, socialize and use the park. Mr. Conklin is asking the Board of Selectmen to accept these donations to the Town for this project.

Mr. Conklin thanked the Parks & Recreation Department and the Department of Public Works for all their help and guidance on the project.

Motion made by Mr. Kaelin to accept the gifts from Kiwanis and the anonymous donor for the River Road project. Motion seconded by Mr. Clune and unanimously carried.

2. Rubber Playground Surfaces & Crumb Rubber Artificial Turf Fields  
Mr. Conklin reviewed the memo attached regarding Rubber Playground Surfaces & Crumb Rubber Artificial Turf Fields and the Conservation Commission's perspective on the topic.
3. Parks & Recreation Commission – Temporary and Portable Lighting Regulation  
Steve Pierce reviewed the request for a zoning regulation change that would permit portable lighting on facilities, with approval of Planning and Zoning on Town and public properties for outdoor recreational and performance event uses. Amendment language and rationale for the amendment is attached. Letters are attached in support of the suggested amendment. Sarah Gioffre, Chair of the Parks and Recreation commission noted that current regulation remains intact and that this is an addition to the regulation. Motion made by Ms. Vanderslice to support the Parks & Recreation Commission moving forward with the proposed zoning regulation change addition of Temporary

and Portable Lighting Regulation to the Planning and Zoning Commission. Motion seconded by Mr. Clune and carried 3-2.

4. Pedestrian Bridge

Ms. Vanderslice noted that she attended a recent meeting with Tighe & Bond, the engineers for the Pedestrian Bridge project. Mike Conklin and Ms. Vanderslice reviewed the attached memo from Town Planner Bob Nerney which gives an update on the project. A timeline and site plan is also attached.

5. Legal Review Committee - RFP

Mr. Clune noted that after the last meeting, additional information was obtained from Sarah Taffel, Director Human Resources and the First Selectman to help streamline the RFP. Items were removed that seemed repetitive. There are 3 documents: Advertisement that covers the first two items of the proposal (Town Counsel is described as the Chief Legal Officer for the Town and as General Counsel to the Board of Selectmen. This leaves it open to the candidates to make a suggestion to us around what they see their role being. The document also includes a non-discrimination certification as well as the Town's 2008 Affirmative Action/Non-discrimination policy/statement. Mr. Kaelin noted resolution needs to be updated as the anti-discrimination statute cited in the document has been updated since 2008. Ms. Vanderslice noted to get new resolution for the next meeting. Motion to approve subject to date change and other minor changes discussed. Motion moved by Mr. Kaelin and seconded by Ms. Bufano and carried 4-1 with Mr. Dubow abstaining as he did not have a chance to read the final version of the RFP as it was not available until that same afternoon.

6. Population Projections

Ms. Vanderslice noted that there was article in paper recently regarding population projections. She received correspondence regarding the article with emphasis on the 0-19 population expected to decrease by 1800 in Wilton referenced. Ms. Vanderslice researched the information and addressed the article. Based on projections, the Miller Driscoll Building School Project once completed would possibly have approximately 6 unused classrooms at the end of construction. As Board of Selectmen, Ms. Vanderslice would like to go back and ask the Architects, Board of Education, The Miller Driscoll Building Committee and Chris Burney, Facilities Manager to look at flexibility in the construction of The Miller Driscoll School.

7. Miller Driscoll Project Scope

Spoke with Glenn Hemmerle and there was discussion around the Media Center for the Miller Driscoll School Project. There was a question if the Miller Driscoll Building Committee could decide to expand the scope of the Miller Driscoll Building Project on their own. Ms Vanderslice mentioned to him that if the Board of Education would like to request a change to the scope of the project they would need to formally discuss and vote on it and bring to the Board of Selectmen

8. Appointments/Reappointments

Appointment of Ben Couch to the Deer Committee – Board of Selectmen would like to interview Mr. Couch before appointing. Moved to June 20, 2016 meeting.

Motion to reappoint John Wilson to the Economic Development Commission by Lori Bufano. Motion seconded by Mr. Clune and unanimously carried.

9. Miscellaneous Other Business

At the next Board of Selectmen meeting will begin discussion of the Gilbert and Bennett Lease as it has expired. Ms. Vanderslice suggested that the Board members visit the Center if they are not familiar with it.

Contract from Shaw for the Turf Field has been reviewed by Town Counsel. Contract is for \$629,000 but bonding was approved for \$650,000. First Selectmen is asking Board of Selectmen for approval to sign the contract. Motion made by Mr. Clune to authorize the First Selectman to approve the contract. Motion seconded by Mr. Dubow and unanimously carried.

Ms. Vanderslice reviewed with the Board of Selectmen the most recent legislative update.

C. Reports

First Selectman's Report

Ms. Vanderslice attended her first meeting of the Board of Education operating workgroup. Special subgroup was formed with Glenn Hemmerle, Richard Creeth and the First Selectman that will be working on a study regarding shared resources between the Board of Education and the Board of Selectmen.

Attended the Comstock Community Center opening on May 18, 2016. Refunding for the project is still on track.

Attended the event for Stay at Home Wilton and Trout Unlimited. Got a better understanding of all that Trout Unlimited does for the Town.

June 20, 2016 Board of Selectmen meeting will have a report from the Fire Station II Building Committee, CFO Anne Kelly-Lenz will give her Financial Report, preliminary reports on 2 Rod Highway and the EDC will be coming in with their analytic survey.

Selectmen's Reports

Ms. Bufano

None

Mr. Clune

None

Mr. Kaelin

Coffee With a Cop – Very impressed with everybody from the patrolmen to the chief.

As there is a need for updating and expansion at Town Hall and other Town facilities, Mr. Kaelin noted that the needs of the whole Town should be looked at during the budget season and there should be more of a balance in terms of distribution between the Board of Selectmen and the Board of Education.

Attended the event at the YMCA which was well attended.

Attended the Pancake Breakfast and the Memorial Service that took place on Memorial Day. Although there was notice that the Memorial Day Parade was cancelled, felt that there should have been notice that the breakfast and memorial service was still ongoing.

Attended the Wilton Library Annual Meeting

CERT is in the process of raising money for an all purpose utility vehicle to be used by the town to be of service for the Fire, Police. Donations can be forwarded to the Town of Wilton UTV Gift Fund and is tax deductible.

Mr. Dubow

Long term perspectives needs to be looked at to understand what is truly driving the numbers.

Attended YMCA event where Karen Birck and Bruce Hampson were honored for their volunteer work with the Town.

D. Public Comment  
None

E. Adjournment – Having no further business, motion made by Ms. Vanderslice to adjourn meeting at 9:20PM. Motion was seconded by Mr. Clune and unanimously carried.



Jacqueline Rochester  
Recording Secretary  
Taken from Video

1



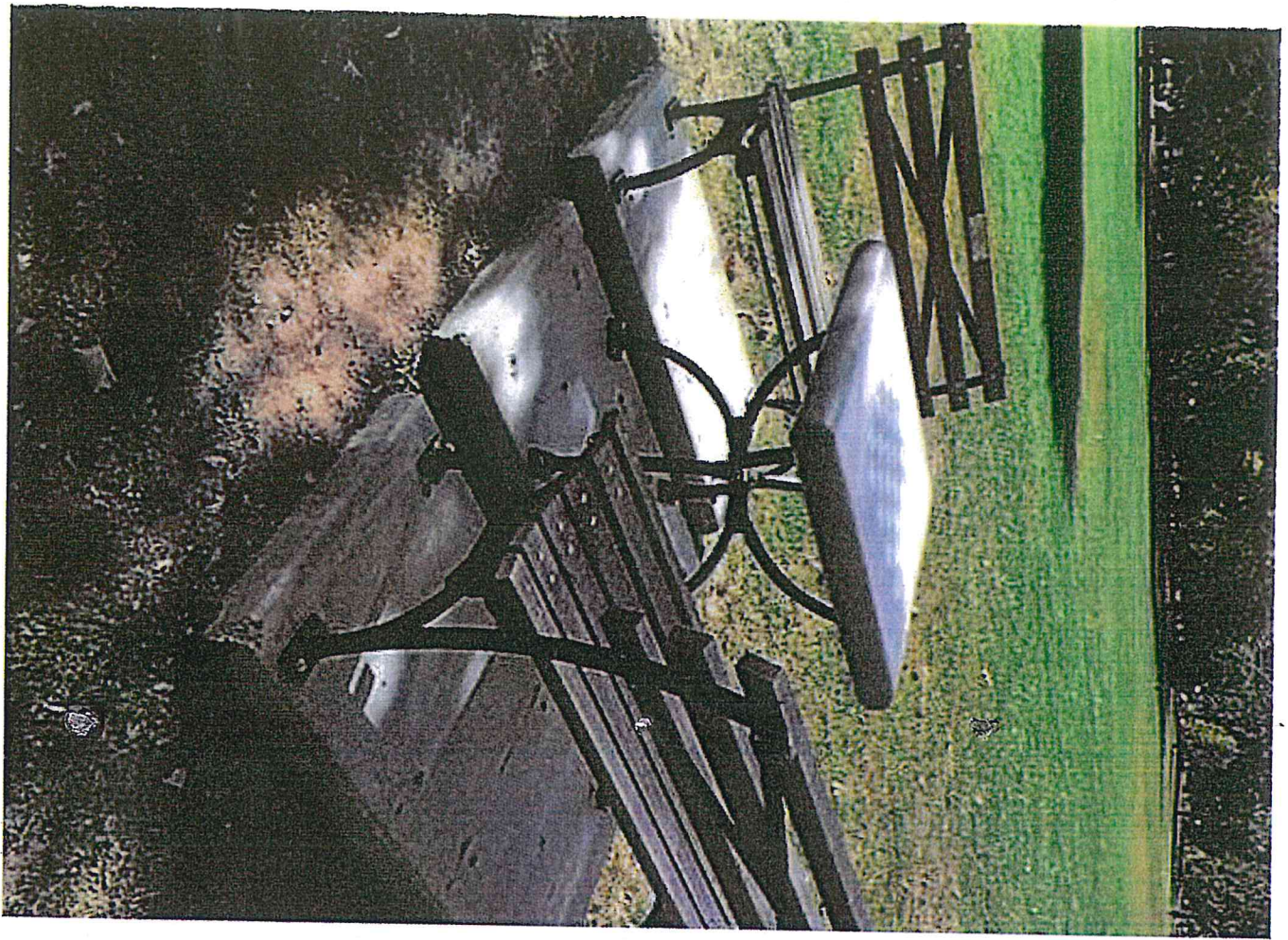

50

51

52

Landscape Design for: Removal of Invasive Species Along River Road Wilton, CT 06897
Lavish Landscapes and Garden Design 308 Westport Road Wilton, Connecticut 06897 (203) 761-9359
Scale: One Inch Equals <del>100</del> 100 Feet
Date: March 15, 2016
Drawn by: Suzanne Knudson

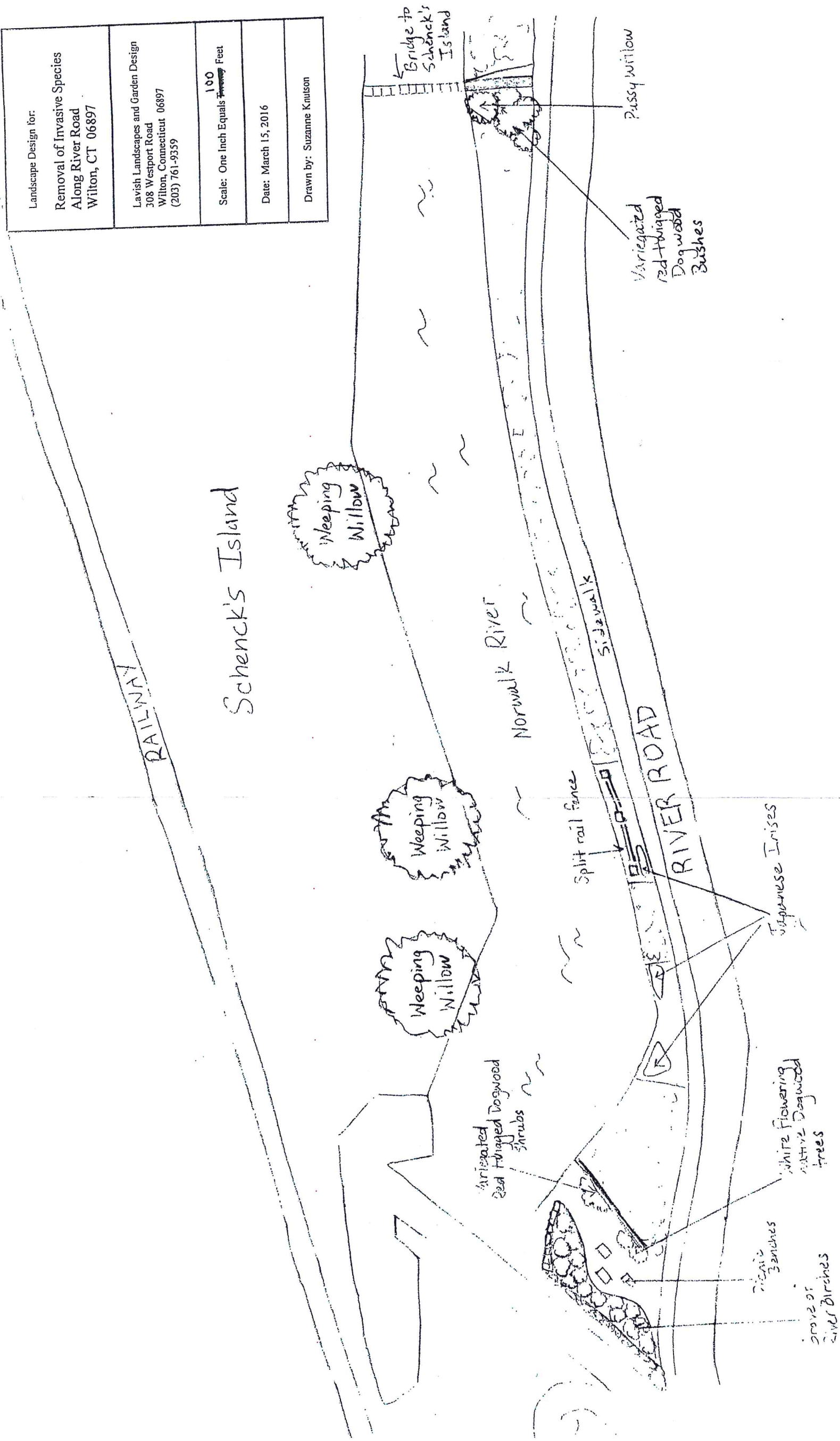

Norwalk River

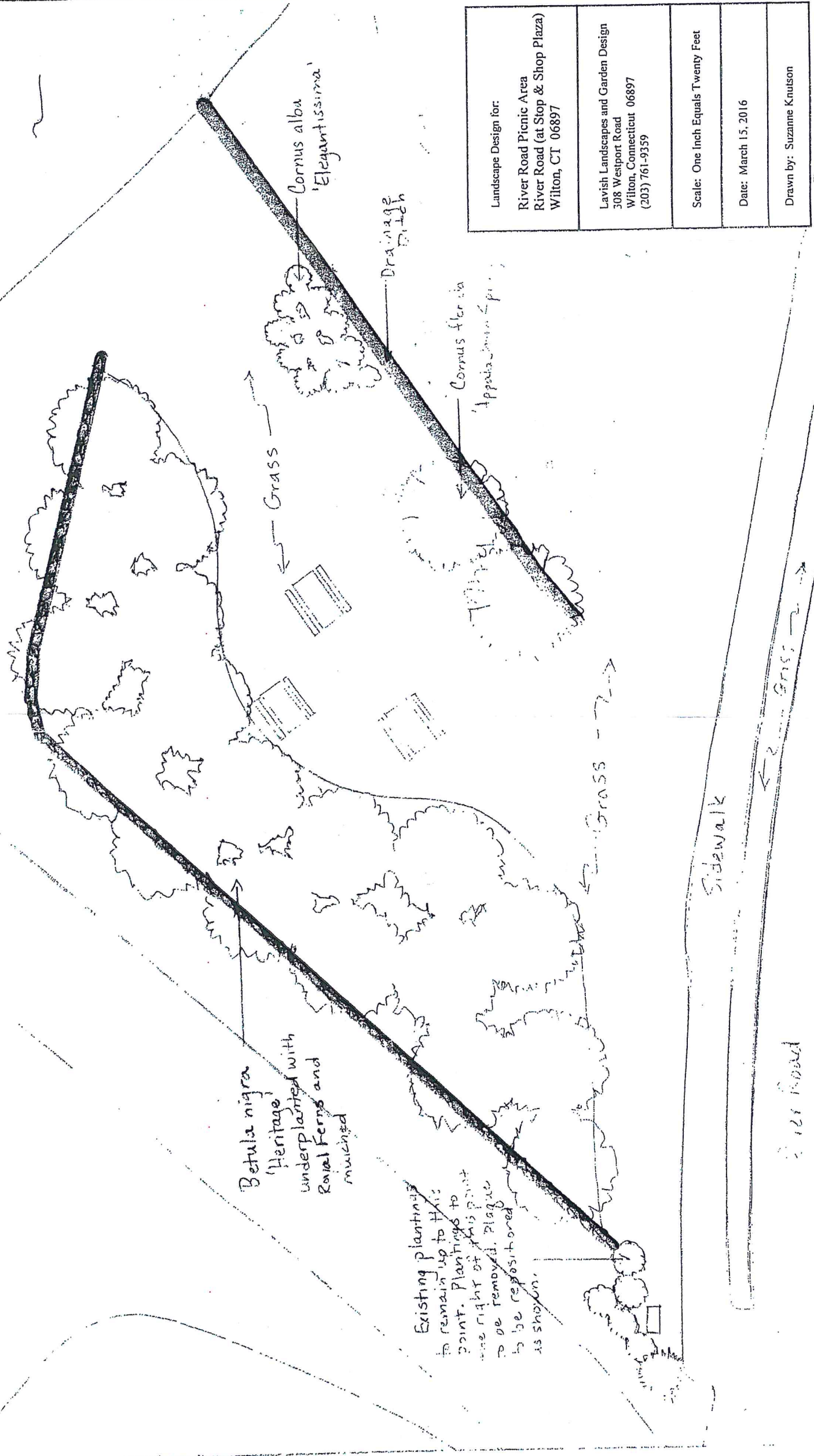

Landscape Design for: River Road Picnic Area River Road (at Stop & Shop Plaza) Wilton, CT 06897	Lavish Landscapes and Garden Design 308 Westport Road Wilton, Connecticut 06897 (203) 761-9359	Scale: One Inch Equals Twenty Feet	Date: March 15, 2016	Drawn by: Suzanne Knutson
--	---	------------------------------------	----------------------	---------------------------

CONSERVATION COMMISSION  
Telephone (203) 563-0180  
Fax (203) 563-0284



TOWN HALL  
238 Danbury Road  
Wilton, Connecticut 06897

## MEMORANDUM

TO: Lynne Vanderslice, First Selectman

FROM: Michael Conklin, Director of Environmental Affairs 

DATE: June 2, 2016

RE: **Rubber Playground Surfaces & Crumb Rubber Artificial Turf Fields**

In the past two years the Conservation Commission has discussed the matter of installing rubber playground surfaces and crumb rubber artificial turf fields in Wilton. When the Commission reviewed this topic for the proposal to construct an artificial turf field at Middlebrook School a scientific report (Connecticut Agricultural Experimental Station, 2009) stated that these rubber surfaces can pollute storm water. More specifically the report stated that when storm water comes in contact with the rubber it results in a leachate that has "zinc concentrations up to ten times the drinking water standards and up to 500 times the surface water protection criteria." The biological evaluation prepared for the Middlebrook School artificial turf field further states the Connecticut DEEP concluded there is a potential risk to surface waters and aquatic organisms from the zinc toxicity of storm water runoff from artificial turf fields.

The Conservation Commission continues to recommend the Town of Wilton consider natural alternatives to the synthetic rubber playground surfaces and the crumb rubber infill used in artificial fields. Whenever possible natural wood fiber playground mulch should be utilized in place of the all too common rubber playground surfaces found in new playgrounds across Connecticut.

Amend Section 29-9.E. of the Zoning Regulations of the Town of Wilton by adding new text known as Section 29-9.E.4:

4. Outdoor Recreational and Performance Event Uses: Notwithstanding the provisions of Section 29-9.E.2. of the Zoning Regulations to the contrary, the temporary lighting or illumination of recreational facilities by way of temporary or portable lighting is permitted with reference to the following standards:
  - a. The temporary and portable lighting shall be granted by Special Permit to address the unique characteristics and circumstances of the site and its surroundings.
  - b. The lighting shall be located on Town or public owned property.
  - c. The temporary and portable lighting facilities may be mounted up to 30 feet above grade.
  - d. All such lighting shall be located and be of such design that no illumination shall be directed to abutting single-family residential properties.
  - e. The source of such lights shall be concealed from abutting single-family residential properties.
  - f. In approving temporary and portable lighting, the Commission may limit the intensity of lighting and the hours of its use where determined necessary to protect adjacent property. Such temporary and portable lights shall be restricted to qualified locations within 1,500 feet of Danbury Road.

## Rationale for Amendment

The proposed regulation is intended to create provisions for the use of temporary and portable lights on Town and public properties for outdoor recreational and performance event uses. This is to accommodate a number of outdoor sport competitions, practices and other recreational activities that frequently occur during evening hours. Such lighting may also be used for events such as outdoor musical concerts, theatrical productions or other outdoor performance-based events.

The proposed amendment is both consistent and compatible with the Wilton 2010 Plan of Conservation and Development. Page 85 of the document discusses the objective of maintaining adequate recreational venues by way of cooperation with inter-town department agencies and private recreation providers. The document notes that 9.8% of those surveyed, see a need for additional active recreation facilities as a top priority (see attachment).

The proposed amendment text appears on a separate page; attached to the application.

## Rochester, Jacqueline

---

**From:** Vanderslice, Lynne  
**Sent:** Monday, June 06, 2016 10:28 AM  
**To:** Rochester, Jacqueline  
**Subject:** Fwd: In support of Temporary and Portable Lighting Regulation

Sent from my iPhone

Begin forwarded message:

**From:** Gino Legaz <[glegaz@gmail.com](mailto:glegaz@gmail.com)>  
**Date:** June 6, 2016 at 9:38:31 AM EDT  
**To:** <[boardofselectmen@wiltonct.org](mailto:boardofselectmen@wiltonct.org)>, "Vanderslice, Lynne"  
<[lynne.vanderslice@wiltonct.org](mailto:lynne.vanderslice@wiltonct.org)>  
**Subject:** In support of Temporary and Portable Lighting Regulation

To the Board of Selectmen:

I would like to express my support for the Temporary and Portable Lighting Regulation that was proposed by the Parks & Recreation Commission.

I urge all the Selectmen to vote Yes so the town can move forward with a comprehensive plan for all athletic fields that will meet the needs of the community and minimize the impact on residential areas.

Thank you.

Gino Legaz

56 McFadden Drive  
Wilton, CT 06897

William and Eliot Patty  
174 Ridgefield Road  
Wilton, CT 06897

June 5, 2016

To the Board of Selectmen:

We are writing to express our wholehearted support for the Amendment for Temporary and Portable Outdoor Lighting crafted and proposed by the Parks and Recreation Commission. We are both impressed and grateful for the thought and effort put into resolving what has become a divisive multi-year struggle between individuals representing Wilton youth sports and the neighborhood near Middlebrook field.

The Middlebrook lights have been used with increasing frequency over the past few years, often left on well into the night and shining onto our house and into our son's bedroom. We are encouraged that the town is advancing a creative solution which will protect all neighborhoods potentially impacted by the use of stadium lighting on our dark skies.

We commend Steve Pierce, director of the Parks and Recreation, and the Parks and Recreation Commission for the diligent effort in both communicating across multiple interested parties and proposing a resolution that effectively creates options which will not negatively impact residential neighborhoods in the future.

Additionally, we fully endorse and appreciate the efforts of our First Selectman for her initiative and resolve to bring everyone to the table and work through what has been a contentious and expensive experience for all of us over the past four years. We certainly never envisioned having to fight so hard to protect our property, its value, and our rights as homeowners in the town we have called home for over 13 years. Creating protection of homes so that "...no illumination shall be directed toward abutting single-family residential properties" and that "the source of such light shall be concealed" will protect many Wilton residents for years to come. Restricting athletic temporary and portable facility lighting to within 1500 feet of Danbury road will effectively preserve the charm of our neighborhoods while allowing for the management and expansion of youth sports activities by the town.

Thank you, Board of Selectmen members, for considering this text amendment. Creating a zone for lit sports facilities makes sense for Wilton as it grows and accommodates the changing needs of its residents. Defining this from the outset will lay the path for considered development of our town in a way that will not threaten the very things that drew us here in the first place.

Sincerely,

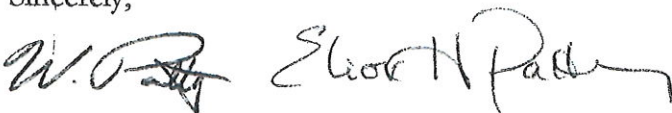
A handwritten signature in black ink, appearing to read "W. O. Patty" followed by a stylized flourish.

William and Eliot Patty

PLANNING & ZONING  
DEPARTMENT  
Telephone (203) 563-0185  
Fax (203) 563-0284  
[www.wiltonct.org](http://www.wiltonct.org)



TOWN OF WILTON  
Town Hall Annex  
238 Danbury Road  
Wilton, Connecticut 06897

## MEMORADUM

TO: Lynne Vanderslice, First Selectman  
FROM: Bob Nerney, Director of Planning and Land Use Management   
RE: Wilton Station Walkway Project Update  
DATE: June 2, 2016

By way of this memorandum, I am providing you with an update of completed work as it pertains to the above referenced project. To date, the project area has been fully surveyed including identification of wetlands and all sub-surface structures and utilities. Borings and soil testing for the bridge abutments have been completed, though additional borings will be required as explained below. Landscape plans including surface treatment, plantings, bridge and pathway lighting, benches and bicycle racks are complete. A structural analysis of the planned prefabricated bridge has been undertaken to address other unique circumstances. These considerations include accommodations for bridge weight loads associated with regional snow loads as well as the ability of the bridge to support snow clearing equipment. Other design considerations include retrofitting both the footings and the under-decking of the bridge to support a future 8" gas line; which may someday provide gas service to both private and Town-owned land holdings on the east side of the Norwalk River.

Meetings have been held with various State regulatory agencies. Town staff and designers have presented conceptual plans to the Connecticut Department of Transportation District 3 Office and the Conn-DOT Rail Division. As part of that review, a historical/archeology survey was undertaken and submitted to the State. Design changes from those meetings have been incorporated into the plans.

A meeting has also taken place with at the Connecticut Department of Energy and Environmental Protection (DEEP) Inland Waters Resource Division who oversee floodplain certification procedures. Though conceptually supportive of the project, IWRD has recommended significant design changes to minimize the amount of fill material necessary to transition from the bridge to the adjoining embankments. These design comments have resulted in a re-positioning of the bridge. Additional soil test boring are in the process of being scheduled accommodate this change.

The attached project timeline describes the remaining scope of design work. Construction drawings are currently 50% complete with continuing and ongoing dialogue expected between the designer, DEEP and DOT. Ninety percent (90%) design completion is expected by the end of August. Local Inland Wetland Agency review is expected to commence shortly as well as submittals to the Army Corps of Engineers and final submittals to CT-DEEP for Flood Management Certification. Discussions with Metro North will commence during this juncture as delivery of infrastructure and staging equipment will necessitate the crossing of the rail line. Final construction design and approvals are expected to occur between November 2016 and January 2017 with actual construction occurring in the spring of 2017.

## Wilton Pedestrian Walkway

27-May-16

[illegible]

